

EQACC SOLAR

Is the angle of solar panels fixed

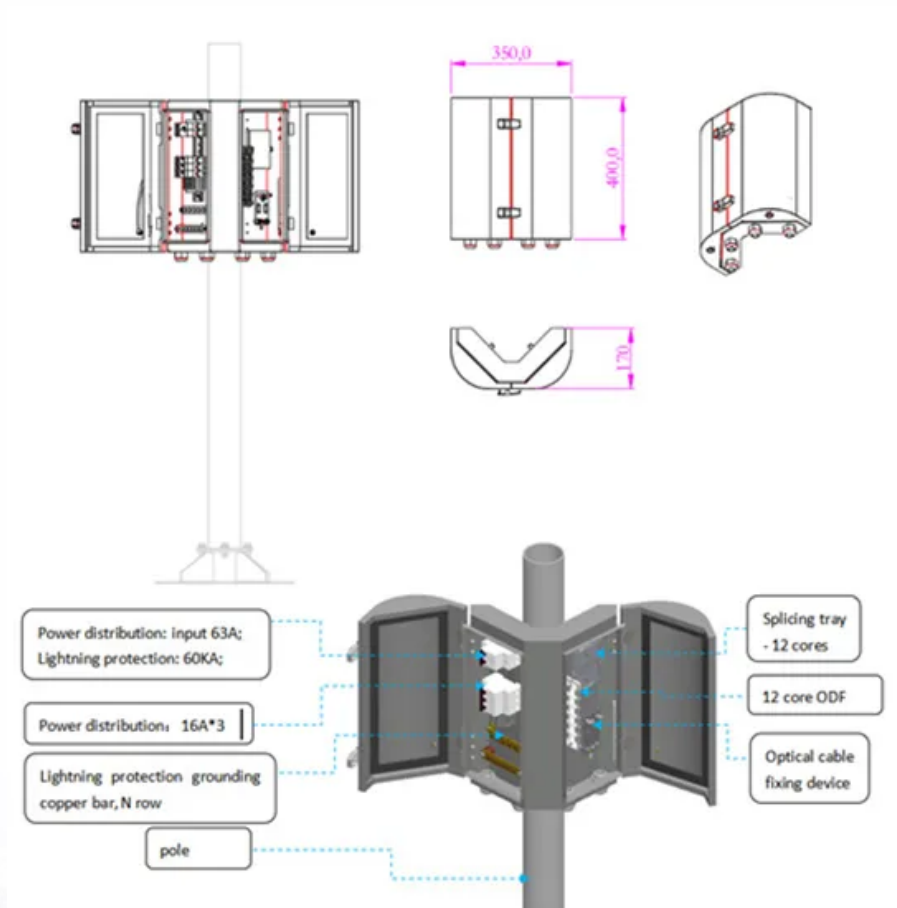

Overview

Why should solar panels be positioned at the best angle?

Positioning solar panels at the best angle is essential for maximizing the efficiency of your solar energy system. The optimal solar panels angle allows the photovoltaic cells to capture the most direct sunlight throughout the year.

Why do solar panels need a different angle?

Another reason the angle is critical is seasonal sunlight variation. In summer, the sun is higher in the sky, while in winter, it's much lower. Adjusting the angle of solar panels to match seasonal changes can improve efficiency by up to 20–25% annually.

What angle should solar panels be installed?

In summer when the sun is higher overhead, a shallower angle closer to horizontal can maximize exposure. For most locations, solar panels installed at a fixed tilt equal to the site latitude +/- 15 degrees will capture reasonable sunlight year-round. However, calculating precise annual and seasonal tilt angles optimizes performance.

What factors affect the ideal solar panel angle?

The single most important consideration affecting the ideal solar panel angle is the latitude of your location on Earth. Latitude tells a location's north or southward distance from the equator. This posture controls the average path and height of the sun in the sky all year long.

Is the angle of solar panels fixed



What is the appropriate angle of solar panels?

The importance of the appropriate angle for solar panels is undeniable. To ensure optimal power output and maximize energy ...

[Get Price](#)

What is the optimal orientation and tilt angle for solar panels ...

In the case of PV-T, when a roof has a fixed slope, it is not necessary to change the angle of the roof to get an optimal production. In fact, the production of energy will always ...



[Get Price](#)



✓ TELECOM CABINET

✓ BRAND NEW ORIGINAL

✓ HIGH-EFFICIENCY

Maximizing Solar Power: The Critical Role Of Solar Panel Angles

A widely accepted and straightforward method for determining the best year-round tilt angle for a fixed solar panel system is to set the tilt angle equal to your location's latitude. ...

[Get Price](#)

Solar Panel Best Angle , Tilt & Orientation ...

A fixed mount holds solar panels at a single, unchanging angle throughout the year. Typically, this angle is set to match the latitude of the ...

[Get Price](#)



What Is The Ideal Angle For Mounting Solar Panels

The "ideal" angle for solar panels is not a one-size-fits-all number-it depends on your location (latitude), energy goals (summer vs. year-round output), and installation type ...

[Get Price](#)

What is the best angle for solar panels - Expert Tips

When it comes to solar panels, angle matters more than you think. The right tilt can boost efficiency, lower energy bills, and make the most of your investment. This guide ...

[Get Price](#)



What is the optimal orientation and tilt angle ...

In the case of PV-T, when a roof has a fixed slope, it is not necessary to change the angle of the roof to get an optimal

production. In ...

[Get Price](#)



Solar Angle Secret: Are Your Panels Tilted Right?

The tilt of your solar panels directly affects the amount of sunlight impacting their surface, thereby determining the generated volume of electricity. Your system's production and ...

[Get Price](#)



What Is the Best Angle to Install Solar Panels on a Roof as Fixed

Choosing the right fixed angle for solar panels involves balancing geographic, structural, and environmental factors. With SIC Solar precision-engineered mounting systems, ...

[Get Price](#)

Solar Angle Secret: Are Your Panels Tilted ...

The tilt of your solar panels directly

affects the amount of sunlight impacting their surface, thereby determining the generated ...

[Get Price](#)

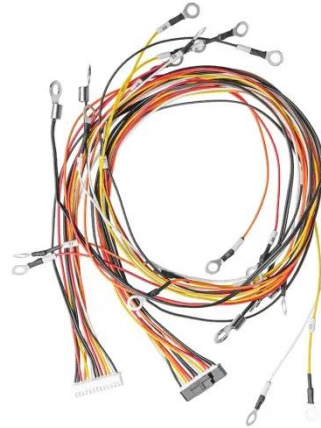

What is the appropriate angle of solar panels? , NenPower

The importance of the appropriate angle for solar panels is undeniable. To ensure optimal power output and maximize energy efficiency, solar installation should remain ...

[Get Price](#)

Solar Panel Best Angle , Tilt & Orientation Guide 2025

A fixed mount holds solar panels at a single, unchanging angle throughout the year. Typically, this angle is set to match the latitude of the installation site or adjusted for the best ...

[Get Price](#)



Photovoltaic Efficiency: Solar Angles & Tracking Systems

Fundamentals Article The angle between a photovoltaic (PV) panel and the sun affects the efficiency of the panel. That



is why many solar angles are used in PV power ...

[Get Price](#)

What is the Best Angle for Solar Panels? Maximizing the

...

Positioning solar panels at the best angle is essential for maximizing the efficiency of your solar energy system. The optimal solar panels angle allows the photovoltaic cells to capture the ...



[Get Price](#)



What is the best angle for solar panels - ...

When it comes to solar panels, angle matters more than you think. The right tilt can boost efficiency, lower energy bills, and make the ...

[Get Price](#)

Contact Us

For catalog requests, pricing, or partnerships, please visit:

<https://www.eqacc.co.za>